

TRITON *Original*

Technical specifications and materials:

All plastic materials used in the manufacture of the Metrodispenser ORIGINAL are approved by European regulations for materials destined to be in contact with food and drink (Directive 2002/72/CEE) and the Food and Drugs Administration (FDA) legislation of the United States of America (CFR 21, 177).

In compliance with food regulations all components in contact with the drink are rotation welded(no adhesives or solvents).

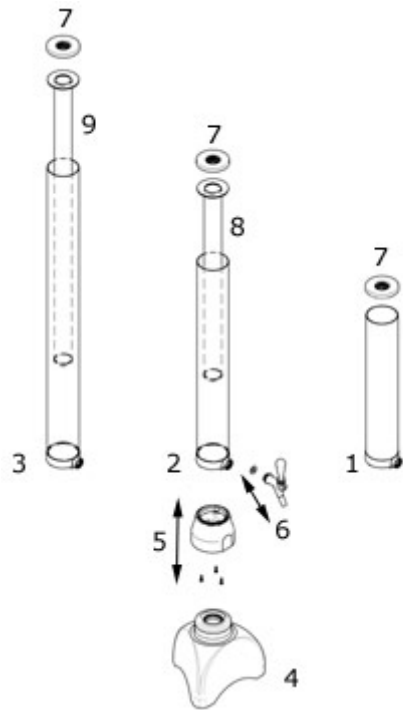

Name	Components	Materials	Contact with drink?	Units	
1	Tube 2L	Tube 2L	PC	yes	1
2	Tube 3L	Tube 3L	PC	yes	1
3	Tube 5L	Tube 5L	PC	yes	1
4	Base assembly	Main body (outer) ABS Crown (inner) PP Ballast Concrete Screws Stainless steel Washers Aluminium	no	1 1 1 3 3	
5	Tube connector assembly	Connector Screws	no	3 3	
6	Tap and sealing ring	Body Closure valve Sealing ring Handle and spout	PC PBT EPDM PBT	yes	1 1 1 1
7	Cap	Cap	PS	yes	1
8	Ice Tube L (accessory)	Ice Tube L	PC	yes	1
9	Ice Tube XL (accessory)	Ice Tube XL	PC	yes	1